

MECHANICAL AND ELECTRICAL SYSTEMS

- Split type air conditioning system for flexible working hours and independent temperature adjustment in each specific zone
- 2 × 28W T5 lighting system
- Pantry area provided in every floor
- 1 office lift in Campus A

LOCATION

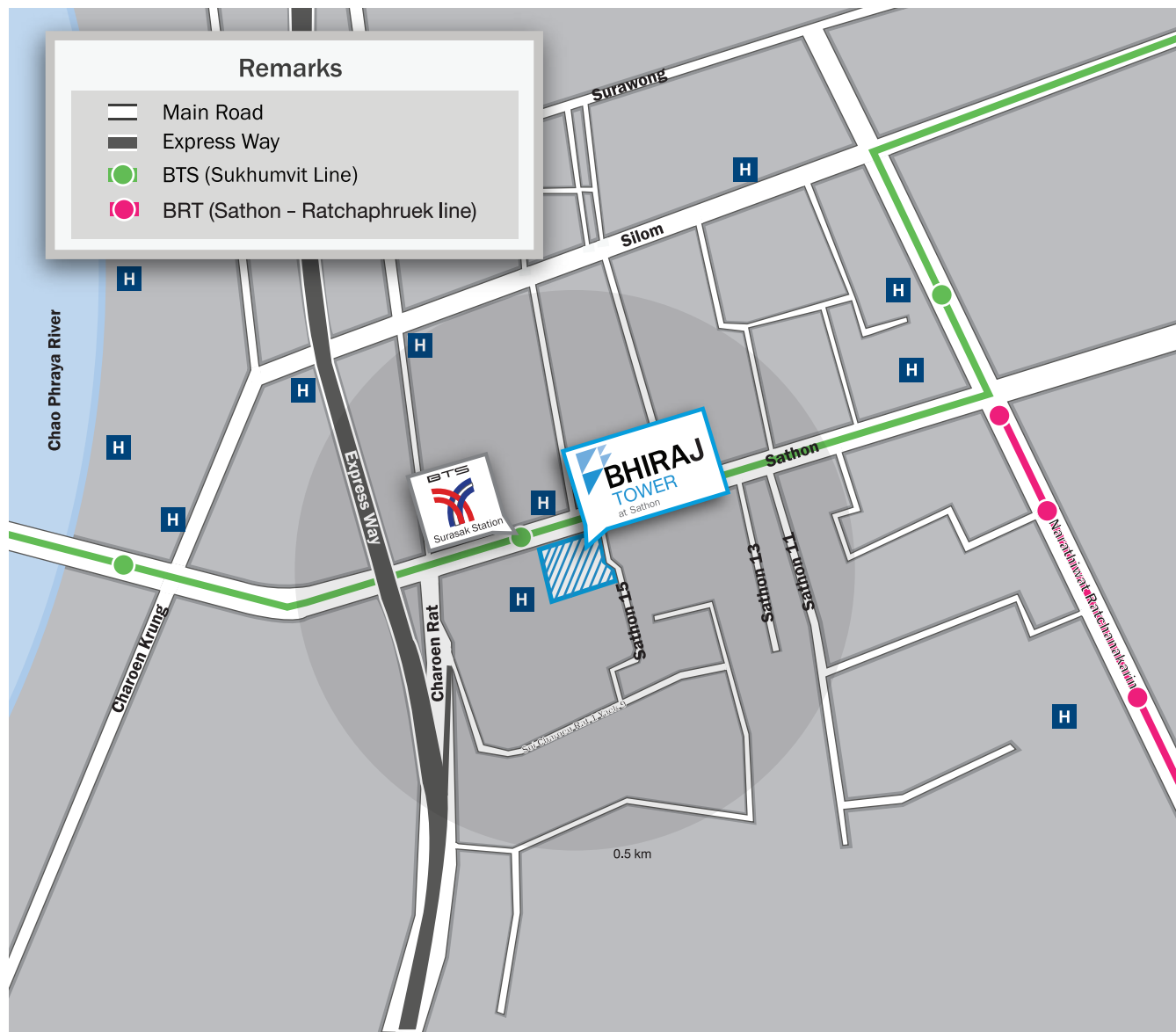

BHIRAJ
TOWER
at Sathon



E-1/2019

FOR LEASING ENQUIRIES, PLEASE CONTACT 02 261 0261#405

BHIRAJ PROPERTY
SOLUTIONS

DEVELOPED AND MANAGED BY

BHIRAJ BURI
www.bhirajburi.co.th

Freedom to Think

www.bhirajburi.co.th



Minimalist interior design concept

Common area inspired from corporate identity

PROJECT HIGHLIGHTS

- 3,200 sq.m. grade-A office campuses in Bangkok's CBD
- Located on Sathon road among the financial institutions and embassies
- Adjacent to Surasak BTS station
- Accessible to Sirat Expressway
- The design incorporates the concept of campus sustainability by having an outdoor landscape and recreation space
- Retail facilities on the ground floor of Campus A

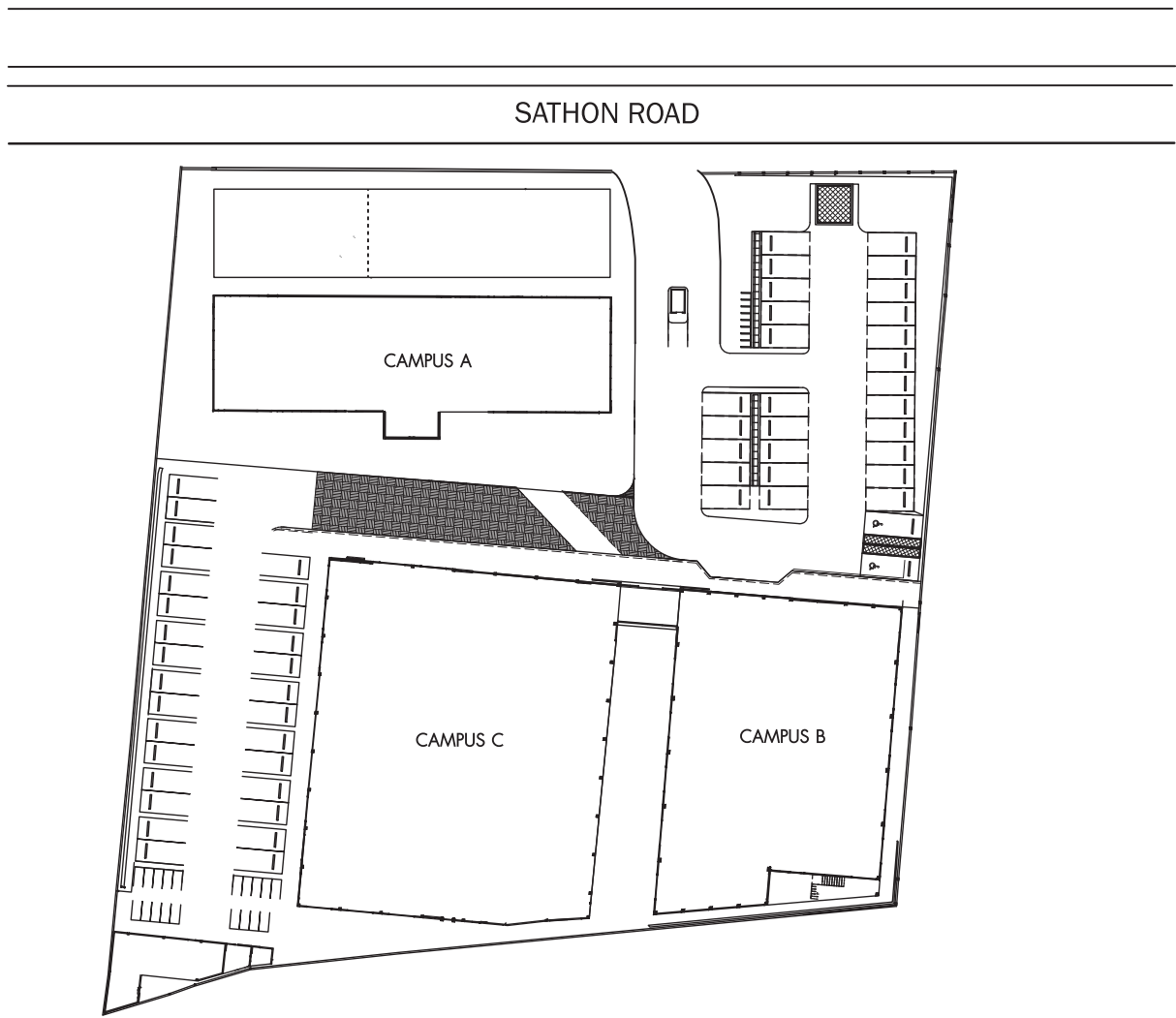

OFFICE SPECIFICATION

- Office lobby for each campus
- Office unit area of 102 - 402 sq.m.
- Ceiling height of 2.70 - 2.90 m.

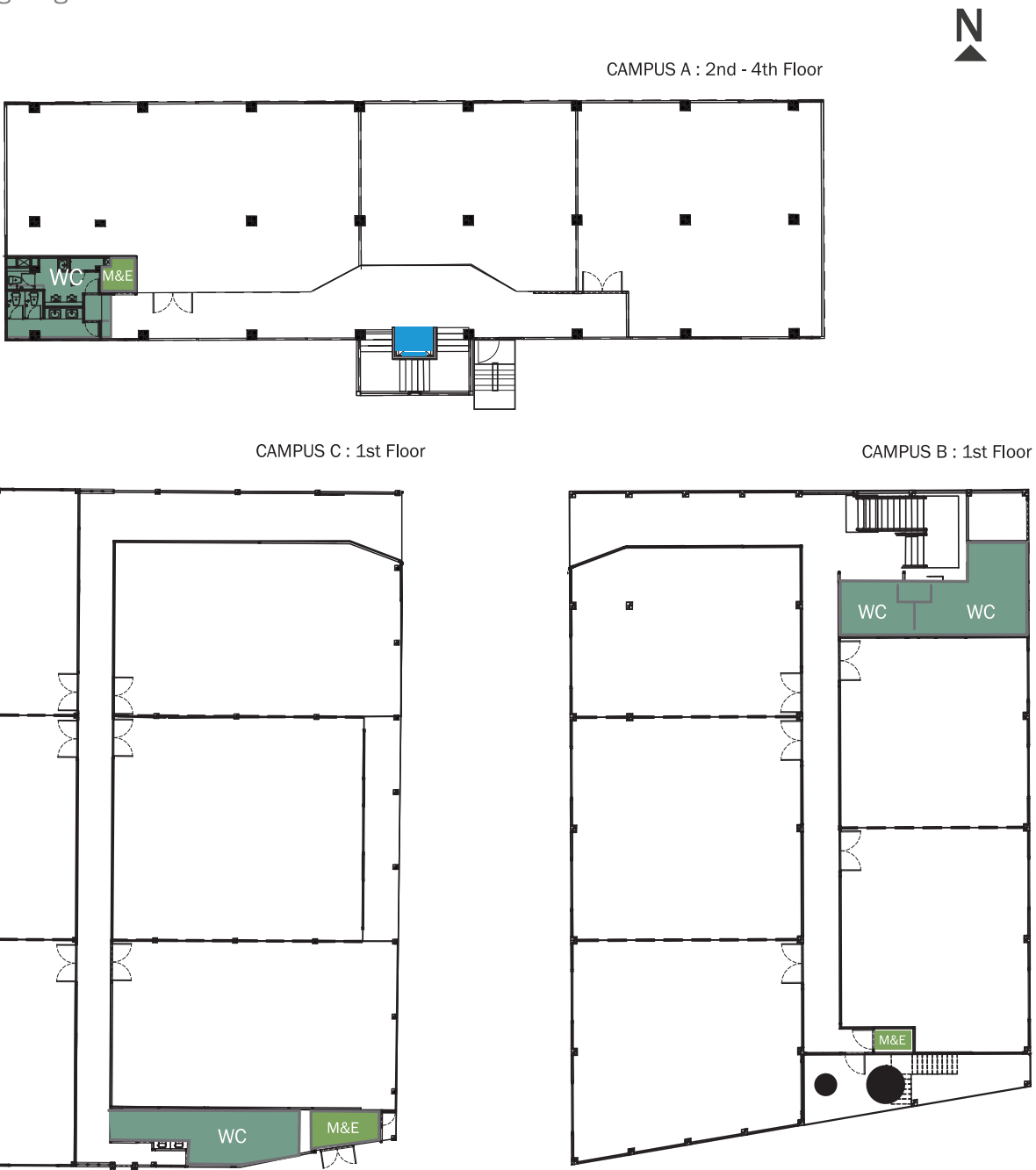

New form of office building that creates social connection



Aerial view of BHIRAJ TOWER at Sathon